

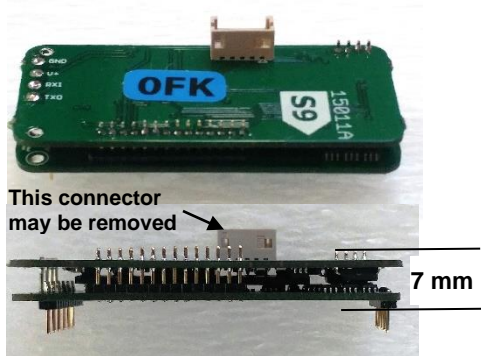

**Inductive Modem Assemblies & Parts**

**15011 OEM Modem Assembly (S9 Footprint)**



**15032 OEM Modem Assembly (SBE IMM Footprint)**

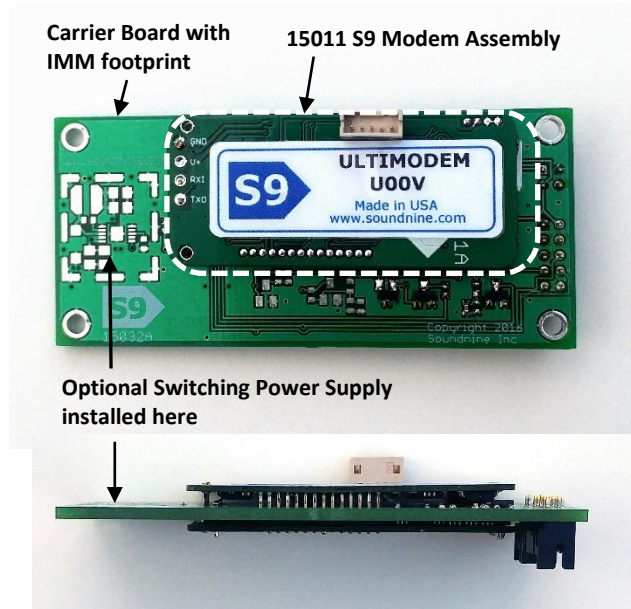

15011 and 15032 Modem Assemblies require an inductive signal coupler, such as 50153 or similar.

**18122 OEM Direct Connect Modem Assembly**



Use 18122 for applications where a direct connection of modem to wire rope is desired.

**50153 Bolt-on Inductive Signal Coupler**

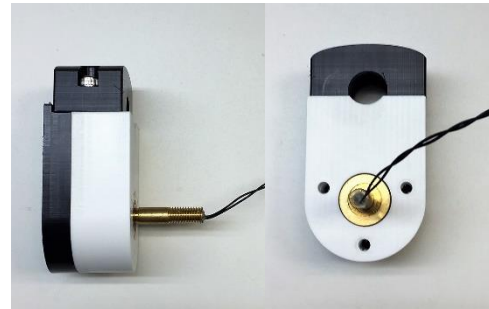

**Parts for OEMs preferring to make their own inductive cable couplers or direct connection**

**5004F Ferrite Toroid Halves**



**5014W Potted Coil**



**5011T Coupling Xfmr**





**Digital Temperature Sensors (RS-232 or Logic Level Serial)**

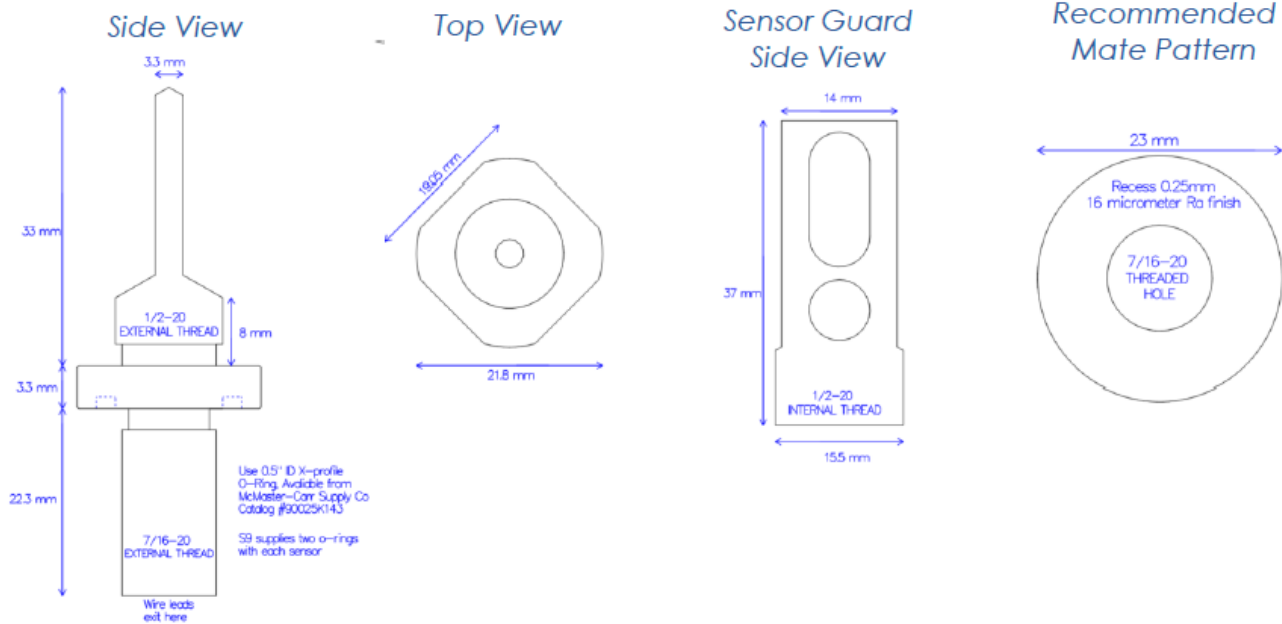



## OEM Price List

### Ulti-modem “plug-in” Replacement Module for SBE IMM (IMM footprint)

	<u>Qty. 1-9</u>	<u>Qty. 10-24</u>	<u>Qty. 25+</u>
PN 15032-1 RS-232 interface	\$ 685	\$ 645	\$ 615
PN 15032-2 Logic level interface	\$ 685	\$ 645	\$ 615
PN 15032-3 RS-232 with power supply	\$ 685	\$ 645	\$ 615
PN 15032-4 Logic level with power supply	\$ 685	\$ 645	\$ 615

### OEM Ulti-modem (S9 Footprint)

	<u>Qty. 1-9</u>	<u>Qty. 10-24</u>	<u>Qty. 25-99</u>	<u>Qty. 100+</u>
PN 15011-1 RS-232 interface	\$ 635	\$ 600	\$ 575	\$ 550
PN 15011-2 Logic level interface	\$ 635	\$ 600	\$ 575	\$ 550

### OEM Ulti-modem – Direct Connect, with power supply

	<u>Qty. 1-9</u>	<u>Qty. 10-24</u>	<u>Qty. 25+</u>
PN 18122-1 RS-232 interface	\$ 785	\$ 745	\$ 715
PN 18122-2 Logic level interface	\$ 785	\$ 745	\$ 715

### OEM Inductive Modem Components

	<u>Qty. 1-9</u>	<u>Qty. 10-24</u>	<u>Qty. 25+</u>
50153 Bolt-on Coupler 15 mm max cable diameter	\$ 675	\$ 600	\$ 575
5006G Bolt-on Coupler, extended, 15 mm max cable diameter	\$ 675	\$ 600	\$ 575
50076 Bolt-on Coupler, large, 25 mm max cable diameter	\$ 825	\$ 735	\$ 700
5002T IM Core Set* With Coil <i>(*includes two 5004F toroid havles &amp; one 5014W coil)</i>	\$ 75	\$ 65	\$ 60
5011T Coupling Transformer	\$ 20	\$ 15	\$ 12

### OEM Temperature Sensor – with guard)

<u>Qty. 1-9</u>
\$ 375 (\$350 without guard )

